

Redevelopment Update January 2010

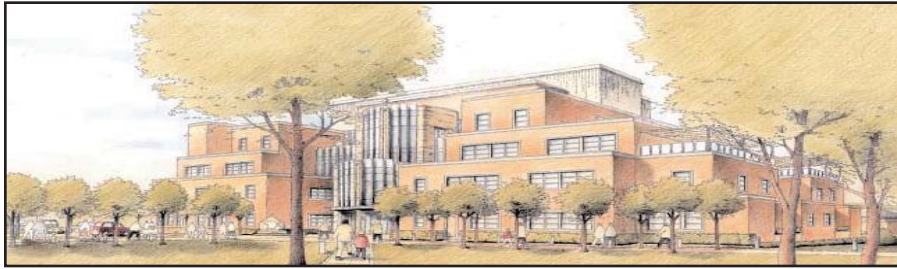

Construction of the new Our Lady of Mercy patient care wing is currently in the concrete forming stages. The second floor concrete slab is complete and the 2nd floor columns along with the third floor concrete slab are underway.

Over the next several months, the rest of the 4-floor structure and 5th floor mechanical penthouse level will be constructed. Construction will then focus on closing in the building and completing the exterior building envelope to protect the interior from the weather so that interior construction can proceed.



**SJHC is holding
our first
redevelopment
community
meeting**

**January 25, 2009
7 to 8 p.m.
Education Centre
A & B**

For more information, questions or concerns regarding our redevelopment project, residents may contact:

Monday to Friday from 9:00 a.m. to 5:00 p.m.:

Corporate Communications & Public Affairs Department at 416-530-6387 or by email at pubaff@stjoe.on.ca.

After regular business hours and on weekends:

For urgent inquiries related to the redevelopment project or site work, please contact the Health Centre's Main Switchboard at 416-530-6000 and they will put you in touch with an on-call Communications Associate.

Redevelopment information and updates are also provided on our website at www.stjoe.on.ca by clicking on "Redevelopment News" on the homepage.