

Redevelopment Update September 2009



St. Joseph's Health Centre is happy to announce that we have received approval from the Ministry of Health and Long-Term Care to award Phase 2 of the construction contract for the new Our Lady of Mercy Wing. One condition placed on the approval to award tender was the Ministry asked that it be made public in a joint event with the Health Centre.

The Honourable David Caplan, Minister of Health, was at St. Joe's Thursday, September 10th for a shovel in the ground ceremony with our staff and physicians.

The contractor, Vanbots, will begin moving onto the construction site immediately and work is expected to start in two weeks.

Our new four-storey patient care wing will help us to provide care for our tiniest patients in a state-of-the-art Neonatal Intensive Care Unit, a new Paediatric Unit, an expanded Family Birthing Centre and Child and Adolescent Mental Health Services. These new

facilities will help us to provide the highest quality of care closer to home for more than 500,000 residents living in Toronto's west end communities.

The 130,000 sq.ft. patient care wing is expected to be completed in two years. It will be built on top of our recently completed three storey underground garage that accommodates parking for 300 cars.

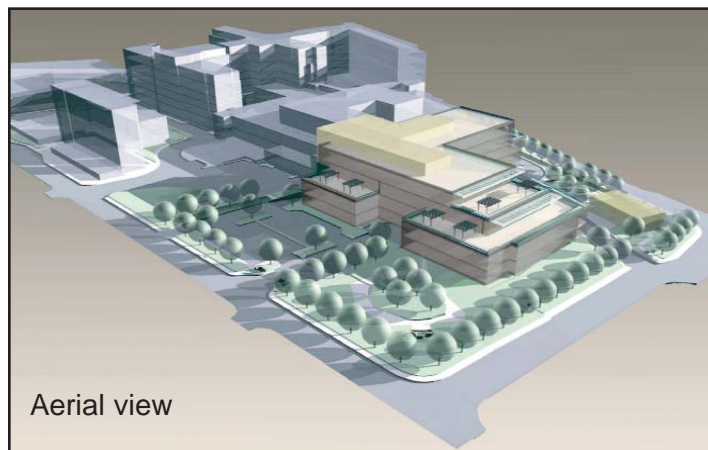

Aerial view

For more information, questions or concerns regarding our redevelopment project, residents may contact:

Monday to Friday from 9:00 a.m. to 5:00 p.m.:

Corporate Communications & Public Affairs Department at 416-530-6387 or by email at pubaff@stjoe.on.ca.

After regular business hours and on weekends:

For urgent inquiries related to the redevelopment project or site work, please contact the Health Centre's Main Switchboard at 416-530-6000 and they will put you in touch with an on-call Communications Associate.

Redevelopment information and updates are also provided on our website at www.stjoe.on.ca by clicking on "Redevelopment News" on the homepage.